

- Legend:
- Alternative Route Design Option
 - Emerging Preferred Route Corridor

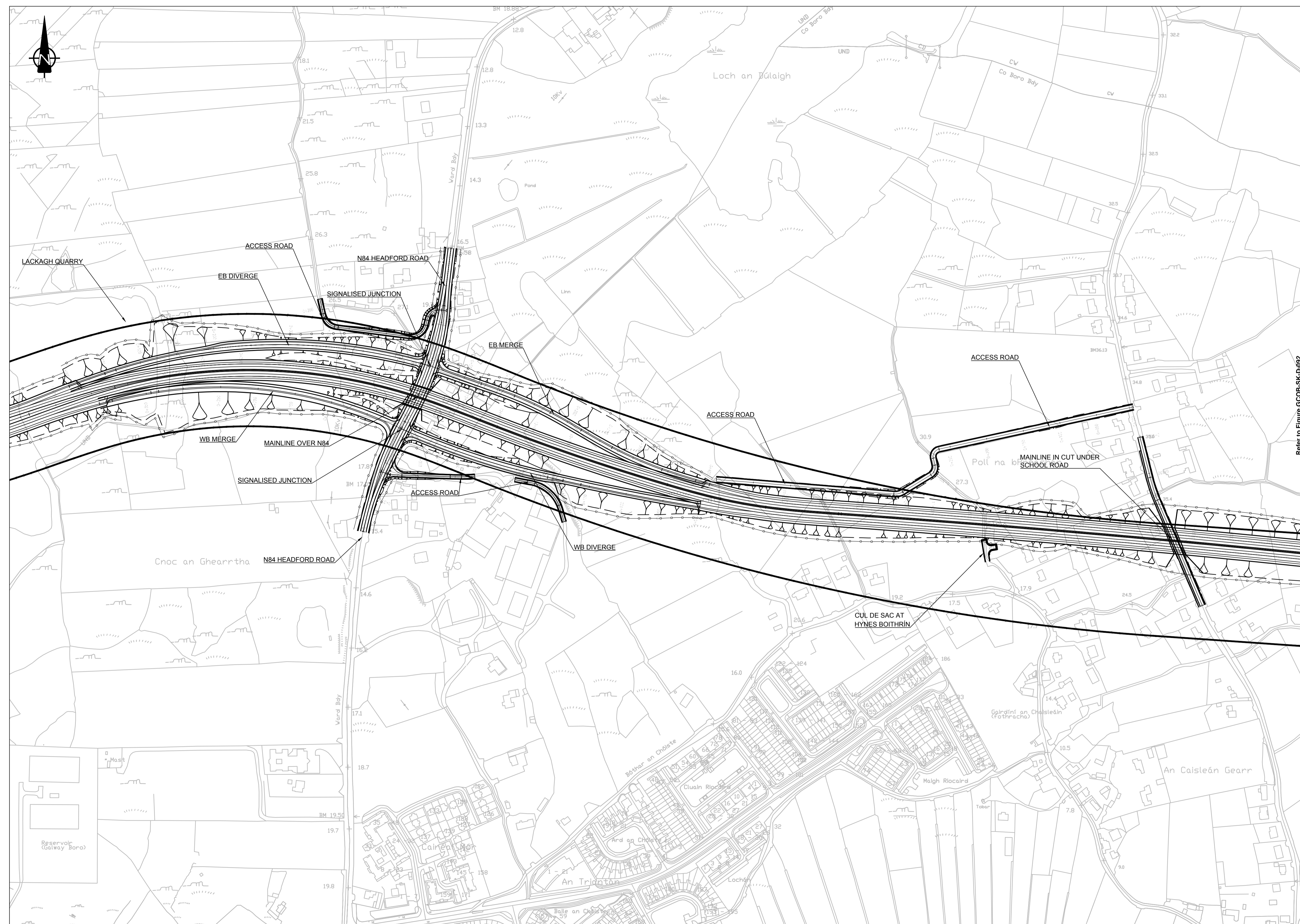

Refer to Figure GCOB-SK-D-092

Includes Ordnance Survey Ireland data reproduced under OSI Licence number 2010/15CCMA/Galway County Council. Unauthorised reproduction infringes Ordnance Survey Ireland and Government of Ireland copyright. © Ordnance Survey Ireland, 2010.

San díreamh tá sonraíocht Shuirbhíreacht Ardánáis Éireann arna atáirgeadh faoi Cheadúnas OSI Uimh. 2010/15CCMA/Comhairle Contae na Galuimne. Sáraíonn atáirgeadh neamhdúraithe cóipeacht Shuirbhíreacht Ardánáis Éireann agus Riailtas na hÉireann. © Suirbhíreacht Ardánáis Éireann, 2010.

Disclaimer Note:
The Design shown is draft only and is subject to change. More detailed assessments, ongoing studies and the information received from the public may result in changes to parts, or all of the Design. Any changes to the Design may affect the other information.

Nóta Sáanta:
Tá an Dearadh ina bhfoirm dréacht, d'fhéadfaí athraithe teacht air. Is mar toradh ar mheasúnaithe níos mionchruinne, ar staidéar leanúnach agus ar eolas ón bpobal a dhéanfaí athruithe teacht ar an Dearadh ina iomláine nó ar chuid de. D'fhéadfadh ag aon athrú ar an Dearadh tionchar a bheith aige ar an eolas eile.



Job Title
N6 Galway City Transport Project

Scale
1:2500 @ A1

Date
October 2015

Issue	Date	By	Chkd	Appd
I2	21/10/2015	GOD	HK	EMC
I1	14/10/2015	GOD	HK	EMC



Drawing Title
N84 Ballindooley to Ballybrit Alternative Design Option A Sheet 1 of 3 - Plan

Drawing Status
For Information

Job No
233985-00

Drawing No
GCOB-SK-D-091

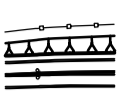
Issue
I2

- Legend:**
-  Alternative Route Design Option
 -  Emerging Preferred Route Corridor

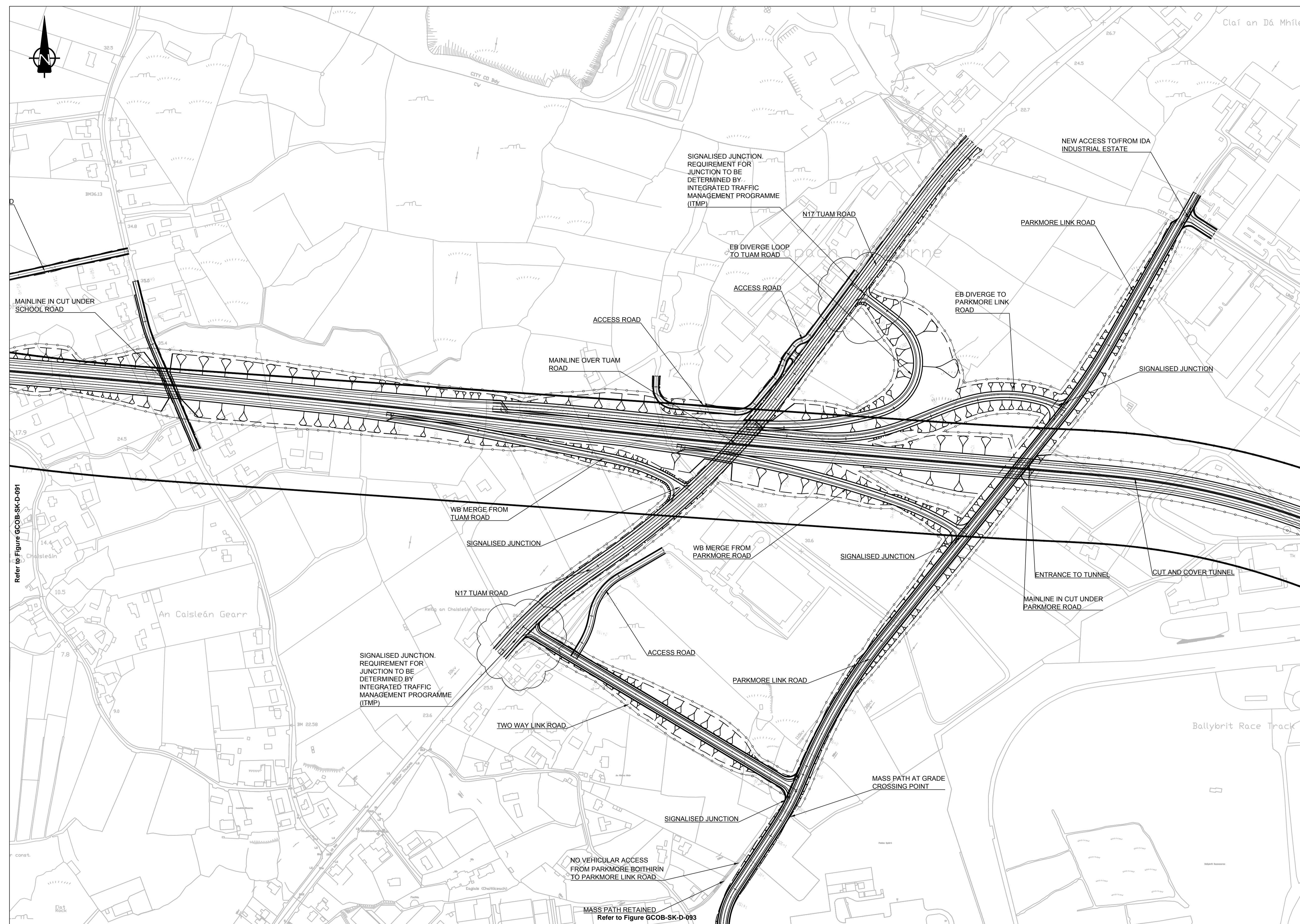

Includes Ordnance Survey Ireland data reproduced under OSI Licence number 2010/15CCMA/Galway County Council. Unauthorised reproduction infringes Ordnance Survey Ireland and Government of Ireland copyright. © Ordnance Survey Ireland, 2010.

San áireamh tá sonraíocht Shuirbhíreacht Ordánais Éireann arna atáirgeadh faoi Cheadúnas OSI Uimh. 2010/15CCMA/Comhairle Contae na Gaillimhe. Sáráirim atáirgeadh neamhláidirthe cópícheart Shuirbhíreacht Ordánais Éireann agus Rialtas na hÉireann. © Suirbhíreacht Ordánais Éireann, 2010.

Disclaimer Note:
The Design shown is draft only and is subject to change. More detailed assessments, ongoing studies and the information received from the public may result in changes to parts, or all of the Design. Any changes to the Design may affect the other information.

Nóta Sáanta:
Tá an Dearadh ina bhfoirm dréacht, d'fhéadfaí athraithe teacht air. Is mar toradh ar mheasúnaithe níos mionchruinne, ar staidéar leanúnach agus ar eolas ón bpobal a dhéanfaí athruithe teacht ar an Dearadh ina iomláine nó ar chuid de. D'fhéadfadh ag aon athrú ar an Dearadh tionchar a bheith aige ar an eolas eile.



Job Title
N6 Galway City Transport Project

Scale
1:2500 @ A1

Date
October 2015

Issue	Date	By	Chkd	Appd
I2	21/10/2015	GOD	HK	EMC
I1	14/10/2015	GOD	HK	EMC

Drawing Title
N84 Ballindooley to Ballybrit Alternative Design Option A Sheet 2 of 3 - Plan

Drawing Status
For Information

Job No
233985-00

Drawing No
GCOB-SK-D-092

Issue
I2

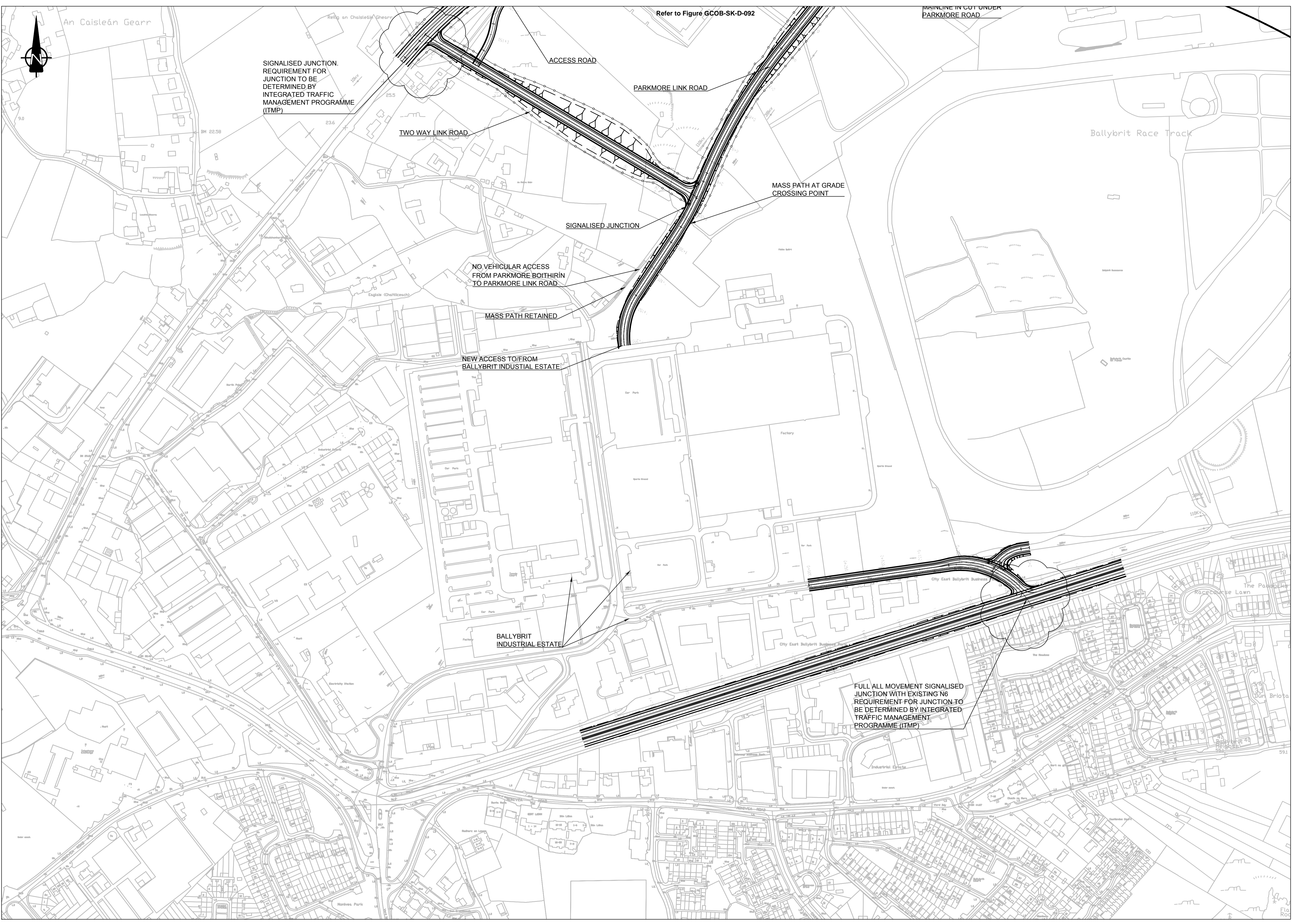

PHASE 3 - DRAFT

Legend:

- Alternative Route Design Option
- Emerging Preferred Route Corridor

SIGNALISED JUNCTION. REQUIREMENT FOR JUNCTION TO BE DETERMINED BY INTEGRATED TRAFFIC MANAGEMENT PROGRAMME (ITMP)

Refer to Figure GCOB-SK-D-092

MASS PATH AT GRADE CROSSING POINT

NO VEHICULAR ACCESS FROM PARKMORE BOITHIRIN TO PARKMORE LINK ROAD

FULL ALL MOVEMENT SIGNALISED JUNCTION WITH EXISTING N6 REQUIREMENT FOR JUNCTION TO BE DETERMINED BY INTEGRATED TRAFFIC MANAGEMENT PROGRAMME (ITMP)

Includes Ordnance Survey Ireland data reproduced under OSI Licence number 2010/15CCMA/Galway County Council. Unauthorised reproduction infringes Ordnance Survey Ireland and Government of Ireland copyright. © Ordnance Survey Ireland, 2010.

San áireamh tá sonraíocht Shuirbhéireacht Ordánais Éireann arna atáirgeadh faoi Cheadúnas OSI Uimh. 2010/15CCMA/Comhairle Contae na Gaillimne. Sáráirim atáirgeadh neamhdánóirthe eolpheart Shuirbhéireacht Ordánais Éireann agus Rialtas na hÉireann. © Suirbhéireacht Ordánais Éireann, 2010.

Disclaimer Note:
The Design shown is draft only and is subject to change. More detailed assessments, ongoing studies and the information received from the public may result in changes to parts, or all of the Design. Any changes to the Design may affect the other information.
Nóta Sáanta:
Tá an Dearadh ina bhfoirm dréacht, d'fhéadfaí athraithe teacht air. Is mar toradh ar mheasúnaithe níos mionchruinne, ar staidéar leanúnach agus ar eolas ón bhpubal a dhéanfaí athruithe teacht ar an Dearadh ina iomláine nó ar chuid de. D'fhéadfadh ag aon athrú ar an Dearadh tionchar a bheith aige ar an eolas eile.

Clients

Consultant

Corporate House
City East Business Park
Ballybrit, Galway, Ireland.

Tel +353 (0)91 460675
www.N6GalwayCity.ie
www.arup.ie

Job Title
N6 Galway City Transport Project

Scale
1:2500 @ A1

Date:
October 2015

Issue	Date	By	Chkd	Appd
I2	21/10/2015	GOD	HK	EMC
I1	14/10/2015	GOD	HK	EMC

Drawing Title
N84 Ballindooly to Ballybrit
Alternative Design Option A
Sheet 3 of 3 - Plan

Drawing Status

For Information

Job No	Drawing No	Issue
233985-00	GCOB-SK-D-093	I2

Legend:

- Alternative Route Design Option
- Emerging Preferred Route Corridor

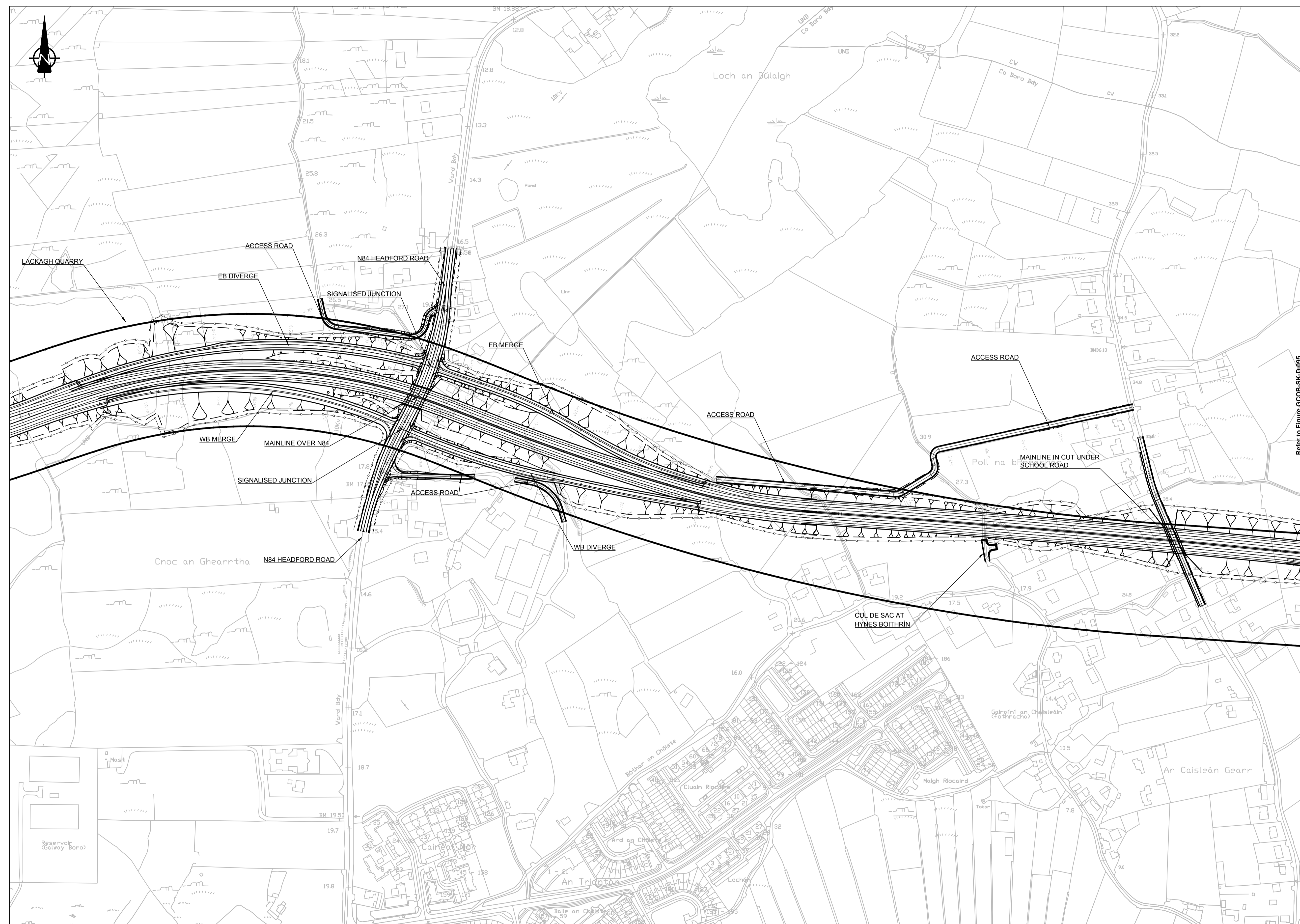

Refer to Figure GCOB-SK-D-095

Includes Ordnance Survey Ireland data reproduced under OSI Licence number 2010/15CCMA/Galway County Council. Unauthorised reproduction infringes Ordnance Survey Ireland and Government of Ireland copyright. © Ordnance Survey Ireland, 2010.

San díreamh tá sonraíocht Shuirbhíreacht Ordánáis Éireann arna atáirgeadh faoi Cheadúnas OSI Uimh. 2010/15CCMA/Comhairle Contae na Galúinne. Sáraithe arís atáirgeadh neamhdáiríthe cóipeacht Shuirbhíreacht Ordánáis Éireann agus Riailtas na hÉireann. © Suirbhíreacht Ordánáis Éireann, 2010.

Disclaimer Note:
The Design shown is draft only and is subject to change. More detailed assessments, ongoing studies and the information received from the public may result in changes to parts, or all of the Design. Any changes to the Design may affect the other information.

Nóta Séanta:
Tá an Dearadh ina bhfoirm dréacht, d'fhéadfaí athraithe teacht air. Is mar toradh ar mheasúnaithe níos mionchruinne, ar staidéar leanúnach agus ar eolas ón bpobal a dhéanfaí athruithe teacht ar an Dearadh ina iomláine nó ar chuid de. D'fhéadfadh ag aon athrú ar an Dearadh tionchar a bheith aige ar an eolas eile.

Clients

Consultant

Corporate House
City East Business Park
Ballybrit, Galway, Ireland.

Tel +353 (0)91 460675
www.N8GalwayCity.ie
www.arup.ie

Job Title
N6 Galway City Transport Project

Scale
1:2500 @ A1

Date:
October 2015

Issue	Date	By	Chkd	Appd
I2	21/10/2015	GOD	HK	EMC
I1	14/10/2015	GOD	HK	EMC

Drawing Title
N84 Ballindooley to Ballybrit
Alternative Design Option B
Sheet 1 of 3 - Plan

Drawing Status
For Information

Job No	Drawing No	Issue
233985-00	GCOB-SK-D-094	I2

- Legend:
- Alternative Route Design Option
 - Emerging Preferred Route Corridor

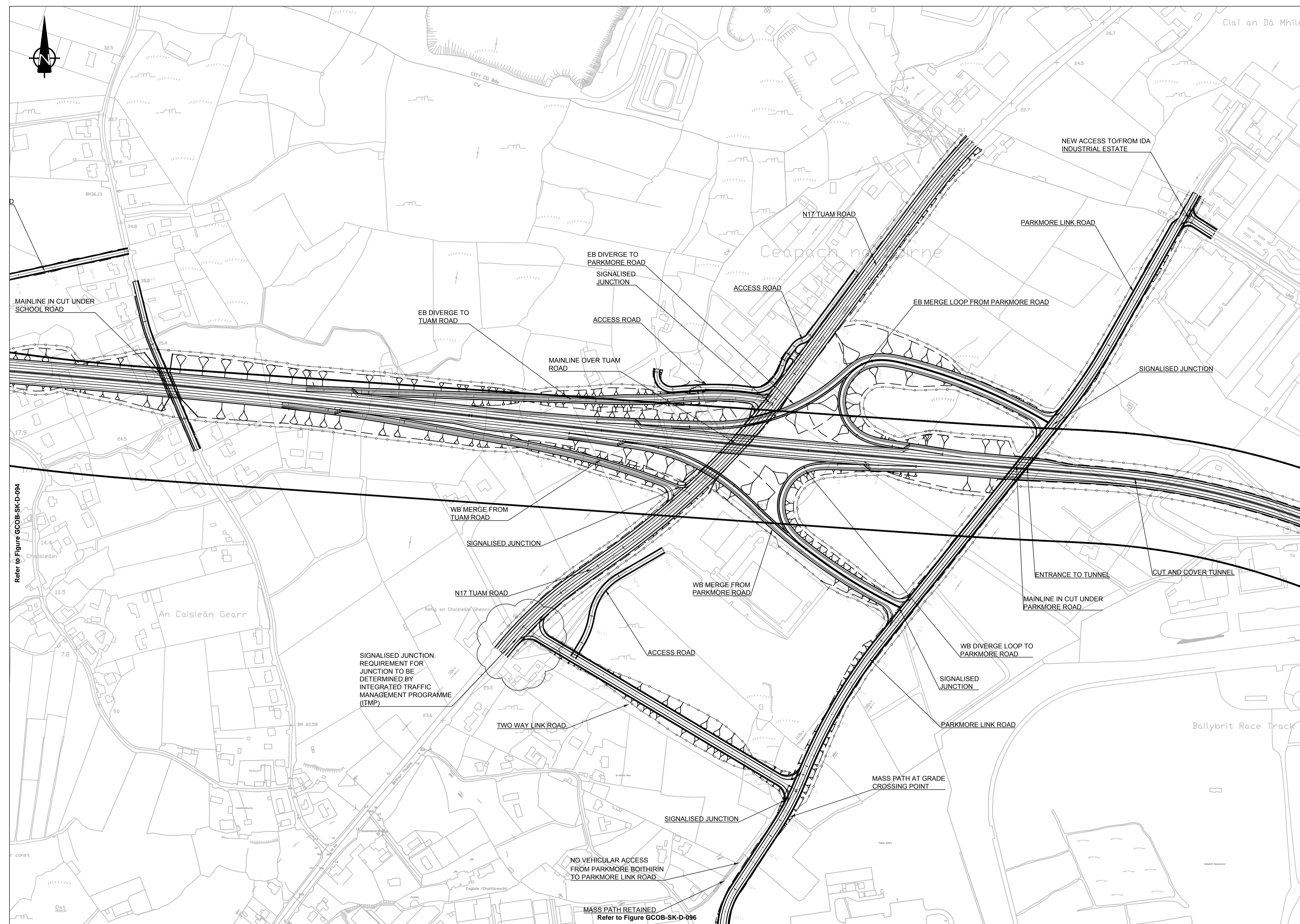

Includes Ordnance Survey Ireland data reproduced under OSI Licence number 2010/15CCMA/Galway County Council. Unauthorised reproduction infringes Ordnance Survey Ireland and Government of Ireland copyright. © Ordnance Survey Ireland, 2010.

San áireamh tá sonraíocht Shuirbhíreacht Ordánais Éireann arna atáirgeadh faoi Cheadúnas OSI Uimh. 2010/15CCMA/Comhairle Contae na Gaillimhe. Sáráirim atáirgeadh neamhdánraíthe cópícheart Shuirbhíreacht Ordánais Éireann agus Rialtas na hÉireann. © Suirbhíreacht Ordánais Éireann, 2010.

Disclaimer Note:
The Design shown is draft only and is subject to change. More detailed assessments, ongoing studies and the information received from the public may result in changes to parts, or all of the Design. Any changes to the Design may affect the other information.

Nóta Séanta:
Tá an Dearadh ina bhfoirm dréacht, d'fhéadfaí athraithe teacht air. Is mar toradh ar mheasúnaithe níos mionchruinne, ar staidéar leanúnach agus ar eolas ón bpobal a dhéanfaí athraithe teacht ar an Dearadh ina iomláine nó ar chuid de. D'fhéadfadh ag aon athrú ar an Dearadh tionchar a bheith aige ar an eolas eile.



Job Title
N6 Galway City Transport Project

Scale
1:2500 @ A1

Date
October 2015

Issue	Date	By	Chkd	Appd
I2	21/10/2015	GOD	HK	EMC
I1	14/10/2015	GOD	HK	EMC

Drawing Title
N84 Ballindooley to Ballybrit Alternative Design Option B Sheet 2 of 3 - Plan

Drawing Status
For Information

Job No
233985-00

Drawing No
GCOB-SK-D-095

Issue
I2

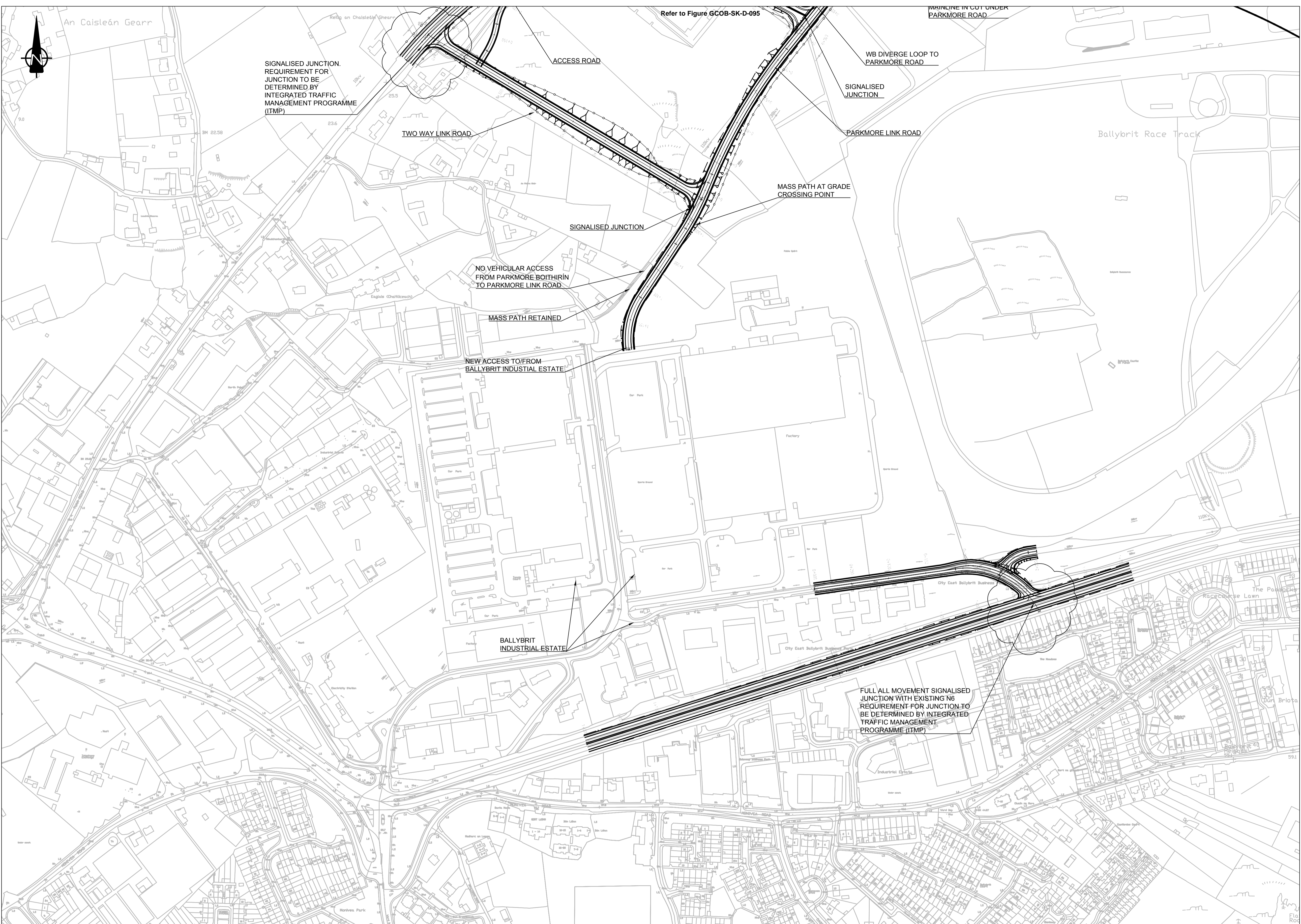

PHASE 3 - DRAFT

- Legend:**
- Alternative Route Design Option
 - Emerging Preferred Route Corridor

Includes Ordnance Survey Ireland data reproduced under OSI Licence number 2010/15CCMA/Galway County Council. Unauthorised reproduction infringes Ordnance Survey Ireland and Government of Ireland copyright. © Ordnance Survey Ireland, 2010.

Son áireamh tá sonraíocht Shuirbhíreacht Ordánais Éireann arna atáirgeadh faoi Cheadúnas OSI Uimh. 2010/15CCMA/Comhairle Contae na Gaillimne. Sáráirim atáirgeadh neamhúdarthaíocht eile. Shuirbhíreacht Ordánais Éireann agus Rialtas na hÉireann. © Suirbhíreacht Ordánais Éireann, 2010.

Disclaimer Note:
The Design shown is draft only and is subject to change. More detailed assessments, ongoing studies and the information received from the public may result in changes to parts, or all of the Design. Any changes to the Design may affect the other information.

Nóta Sáanta:
Tá an Dearadh ina bhfoirm dréacht, d'fhéadfaí athraithe teacht air. Is mar toradh ar mheasúnaithe níos mionchruinne, ar staidéar leanúnach agus ar eolas ón bpobal a dhéanfaí athruithe teacht ar an Dearadh ina iomláine nó ar chuid de. D'fhéadfadh ag aon athrú ar an Dearadh tionchar a bheith aige ar an eolas eile.

Clients

Galway City Transport Project

Consultant

Corporate House
City East Business Park
Ballybrit, Galway, Ireland.

Tel +353 (0)91 460675
www.N6GalwayCity.ie
www.arup.ie

Job Title
N6 Galway City Transport Project

Scale
1:2500 @ A1

Date:
October 2015

Issue	Date	By	Chkd	Appd
I2	21/10/2015	GOD	HK	EMC
I1	14/10/2015	GOD	HK	EMC

Drawing Title
N84 Ballindooly to Ballybrit
Alternative Design Option B
Sheet 3 of 3 - Plan

Drawing Status
For Information

Job No
233985-00

Drawing No
GCOB-SK-D-096

Issue
I2