

FOR INFORMATION

- Legend:**
- City Boundary
 - Proposed Development Boundary
 - Proposed Road Geometry
 - Proposed Road Development (Earthworks Indicative Fill)
 - Proposed Road Development (Earthworks Indicative Cut)
 - Structure (S)
 - Proposed Retaining wall (R)
 - Proposed Mammal Underpass (C)
 - Proposed Culvert (C)
 - Proposed Attenuation Pond / Infiltration Basin
 - Proposed Stream Diversion

Includes Ordnance Survey Ireland data reproduced under OSI Licence number 2010/16CCMA/Galway County Council. Unauthorised reproduction infringes Ordnance Survey Ireland and Government of Ireland copyright. © Ordnance Survey Ireland, 2010.

Son áireamh tá sonraíocht Shuirbhíreacht Ordánais Éireann arna atáirgeadh faoi Cheadúnas OSI Uimh. 2010/16CCMA/Cumhairle Contae na Gaillimhe. Sábalonn atáirgeadh neamhdharaíthe cóisheacht Shuirbhíreacht Ordánais Éireann agus Rialtas na hÉireann. © Suirbhíreacht Ordánais Éireann, 2010.

Disclaimer Note:
The Design shown is draft only and is subject to change. More detailed assessments, ongoing studies and the information received from the public may result in changes to parts, or all of the Design. Any changes to the Design may affect the other information.

Nóta Sáanta:
Tá an Deardadh ina bhfoirm dréacht, d'fhéadfaí athraithe teacht air. Is mar toradh ar mheasúnaithe níos mionchruinne, ar staidéar leanúnach agus ar eolas ón bpobal a dhéanfaí athruithe teacht ar an Deardadh ina iomláine nó ar chuid de. D'fhéadfadh ag aon aithri ar an Deardadh tionchar a bheith aige ar an eolas eile.

Clients

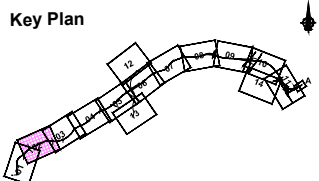

Consultant

Corporate House
City East Business Park
Ballybrit, Galway, Ireland.

Tel +353 (0)91 460675
www.N6GalwayCity.ie
www.arup.ie

Job Title
N6 Galway City Ring Road

Scale
1:5000 @ A3

Date:
November 2016

Issue	Date	By	Chkd	Appd
D1	14/11/2016	KJ	MH	EMC

Drawing Title
Proposed Road Development Plan Layout
CH.14-350 to CH.2+778
Sheet 2 of 14

Drawing Status
For Information

Job No 233985	Drawing No GC0B-SK-D-758	Issue D1
-------------------------	------------------------------------	--------------------