

**FOR INFORMATION**

- Legend:**
- City Boundary
  - Proposed Development Boundary
  - Proposed Road Development (Earthworks Indicative Fill)
  - Proposed Road Development (Earthworks Indicative Cut)
  - Structure (S)
  - Proposed Retaining wall (R)
  - Proposed Mammal Underpass (C)
  - Proposed Culvert (C)
  - Proposed Attenuation Pond / Infiltration Basin
  - Proposed Stream Diversion

**Disclaimer Note:**  
 The Design shown is draft only and is subject to change. More detailed assessments, ongoing studies and the information received from the public may result in changes to parts, or all of the Design. Any changes to the Design may affect the other information.

**Nóta Sáanta:**  
 Tá an Deardadh ina bhfoirm dréacht, d'fhéadfaí athraithe teacht air. Is mar toradh ar mheasúnaithe níos mionchruinne, ar staidéar leanúnach agus ar eolas ón bpobal a dhéanfaí athruithe teacht ar an Deardadh ina iomláine nó ar chuid de. D'fhéadfadh ag aon athrú ar an Deardadh tionchar a bheith aige ar an eolas eile.

Clients

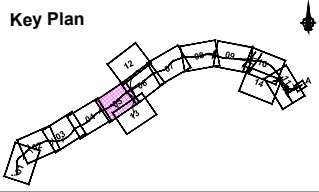

Consultant

Corporate House  
 City East Business Park  
 Ballybrit, Galway, Ireland.

Tel +353 (0)91 460675  
 www.N6GalwayCity.ie  
 www.arup.ie

Job Title  
**N6 Galway City Ring Road**

Scale  
 1:5000 @ A3

Date:  
 November 2016

Issue	Date	By	Chkd	Appd
D1	14/11/2016	KJ	MH	EMC

Drawing Title  
 Proposed Road Development Plan Layout  
 CH.5+800 to CH.7+300  
 Sheet 5 of 14

Drawing Status  
**For Information**

Job No  
**233985**

Drawing No  
**GC0B-SK-D-761**

Issue  
**D1**