

**FOR INFORMATION**

- Legend:**
- City Boundary
  - Proposed Development Boundary
  - Proposed Road Geometry
  - Proposed Road Development (Earthworks Indicative Fill)
  - Proposed Road Development (Earthworks Indicative Cut)
  - Structure (S)
  - Proposed Retaining wall (R)
  - Proposed Mammal Underpass (C)
  - Proposed Culvert (C)
  - Proposed Attenuation Pond / Infiltration Basin
  - Proposed Stream Diversion

**Disclaimer Note:**  
 The Design shown is draft only and is subject to change. More detailed assessments, ongoing studies and the information received from the public may result in changes to parts, or all of the Design. Any changes to the Design may affect the other information.

**Nóta Sáanta:**  
 Tá an Deardadh ina bhfoirm dréacht, d'fhéadfaí athraithe teacht air. Is mar toradh ar mheasúnaithe níos mionchruinne, ar staidéar leanúnach agus ar eolas ón bpobal a dhéanfaí athruithe teacht ar an Deardadh ina iomláine nó ar chuid de. D'fhéadfadh ag aon aithri ar an Deardadh tionchar a bheith aige ar an eolas eile.

**Clients**

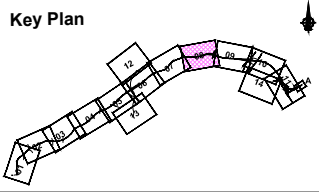

**Consultant**

Corporate House  
 City East Business Park  
 Ballybrat, Galway, Ireland.

Tel +353 (0)91 460675  
 www.N6GalwayCity.ie  
 www.arup.ie

**Job Title**  
 N6 Galway City Ring Road

**Scale**  
 1:5000 @ A3

**Date:**  
 November 2016

Issue	Date	By	Chkd	Appd
D1	14/11/2016	KJ	MH	EMC

**Drawing Title**  
 Proposed Road Development Plan Layout  
 CH.10+550 to CH.12+200  
 Sheet 8 of 14

**Drawing Status**  
**For Information**

Job No	Drawing No	Issue
233985	GC0B-SK-D-764	D1

Includes Ordnance Survey Ireland data reproduced under OSI Licence number 2010/16CCMA/Galway County Council. Unauthorised reproduction infringes Ordnance Survey Ireland and Government of Ireland copyright. © Ordnance Survey Ireland, 2010.

Son áireamh tá sonraíocht Shuirbhíreacht Ordánais Éireann arna atáirgeadh faoi Cheadúnas OSI Uimh. 2010/16CCMA/Comhairle Contae na Gaillimhe. Sárú ar na sonraíochtaí neamhúdarthaí coischeart Shuirbhíreacht Ordánais Éireann agus Rialtas na hÉireann. © Suirbhíreacht Ordánais Éireann, 2010.