

FOR INFORMATION

- Legend:**
- City Boundary
 - Proposed Development Boundary
 - Proposed Road Geometry
 - Proposed Road Development (Earthworks Indicative Fill)
 - Proposed Road Development (Earthworks Indicative Cut)
 - Structure (S)
 - Proposed Retaining wall (R)
 - Proposed Mammal Underpass (C)
 - Proposed Culvert (C)
 - Proposed Attenuation Pond / Infiltration Basin
 - Proposed Stream Diversion

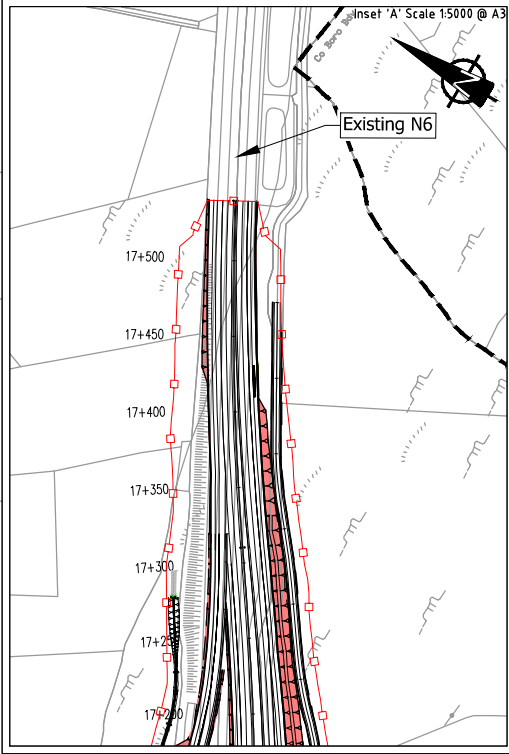

Disclaimer Note:
 The Design shown is draft only and is subject to change. More detailed assessments, ongoing studies and the information received from the public may result in changes to parts, or all of the Design. Any changes to the Design may affect the other information.

Nóta Sáanta:
 Tá an Deardadh ina bhfoirm dréacht, d'fhéadfaí athraitheacht air. Is mar toradh ar mheasúnaithe níos mionchruinne, ar staidéir leanúnach agus ar eolas ón bpobal a dhéanfaí athruithe teacht ar an Deardadh ina iomláine nó ar chuid de. D'fhéadfadh ag aon aithri ar an Deardadh tionchar a bheith aige ar an eolas eile.

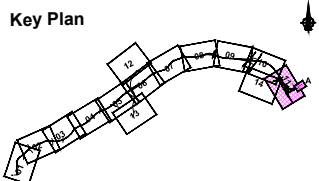

Job Title
N6 Galway City Ring Road

Scale
 1:5000 @ A3

Date:
 November 2016

Issue	Date	By	Chkd	Appd
D1	14/11/2016	KJ	MH	EMC

Drawing Title
 Proposed Road Development Plan Layout
 CH.15+450 to CH.17+460 (End of Scheme)
 Sheet 11 of 14

Drawing Status
For Information

Job No	Drawing No	Issue
233985	GC0B-SK-D-767	D1